

**NOTES:**

1. To be tightened according to Aprilia Tuareg 660 Workshop Manual.
2. Do not use Loctite or other thread locking compounds. Use copper grease.

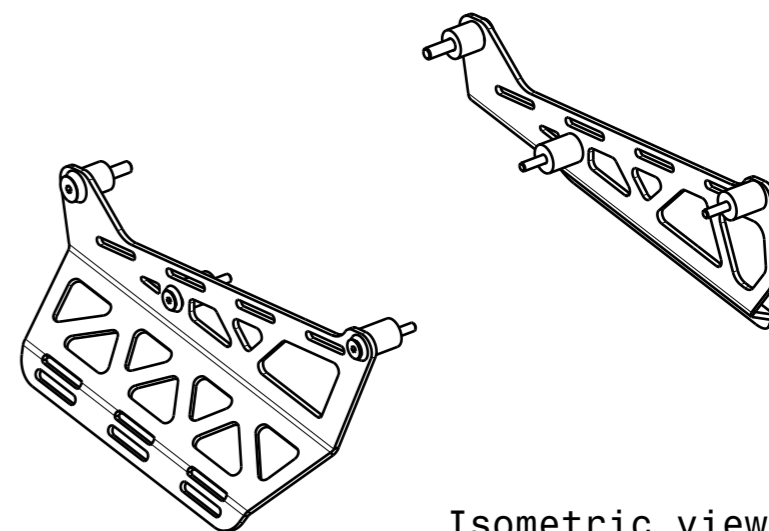

Isometric view  
Scale: 1:5

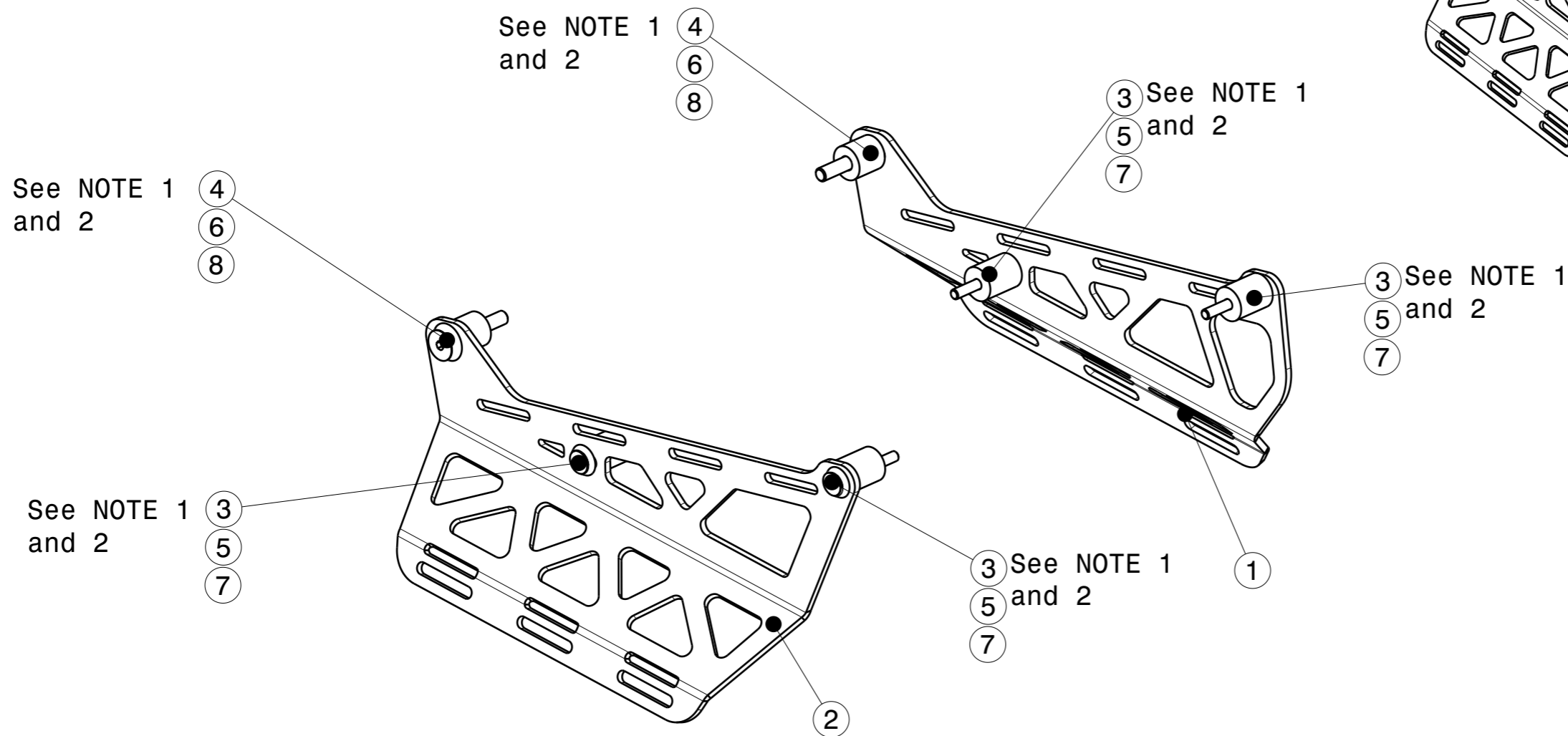

Isometric view  
Scale: 1:3

PART LIST			
Description	Part Number	F/N	Qty
Siderack Solo L	FGWX-05-C-001	1	1
Siderack Solo R	FGWX-05-C-002	2	1
Spacer 6x20x25		3	4
Spacer 8x20x20		4	2
Csk Washer M6		5	4
Csk Washer M8		6	2
Csk Screw M6x50		7	4
Csk Screw M8x50		8	2

SCALE 1:1	BREAK ALL EDGES (R ALT. 45°) 0.1-0.5 THREAD TOL. 6g/6H ISO R965/1 ALL DIM. INCLUDE SURFACE TREATMENT	<b>GWORX</b>	
ROUGH Ra μm -	FILLET RADII -	DIM TOL -	ANG TOL -
DATE -	DESCRIPTION Siderack Solo		
DESIGN GWORX	-		
DRAWN GWORX	-		
MAT. -	SURF. TREATMENT -		
SIZE -	DOC.NO. FGWX-05-C	REV. -	SHEET 1 OF 1